



Kina



Kina

Kina references the inner shell of the local salt water sea-urchin called kina in Māori. David saw a kina shell in Antarctica – nestled in a tiny hollow in the sea ice. The shell had absorbed enough warmth from the sun to melt into the ice around it.

Kina is available in various sizes to suit any space. The plywood finish can be either raw bamboo or painted, offering a range of options.



Features

Shipped Kitset

Seed System kitset lightshades are on average 1/30th of the volume of the assembled light. This aims to help minimize the effects of shipping and to reduce the design's environmental footprint.

Warranty

This light is warranted for three years from date of purchase for failure of parts.

Care Instructions

All lights are intended for use in dry interior conditions only and can be cleaned with a soft cloth dampened slightly in warm water when the light is switched off. Do not use detergents.

EPD Certified

An EPD is a standardised and verified way of quantifying the environmental impacts of a product, based on a consistent set of rules that have been developed through a stakeholder consultation process.



Compliance



CE



AS/NZS

(Declarations of conformity available on request).

Kina
800mm (31")

Apex
1.5m





Technical Data

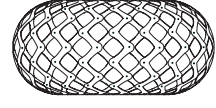
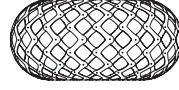
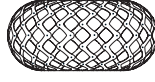

440mm/17"

600mm/24"

800mm/31"

1000mm/39"

1400mm/55"

Width: 440mm / 17" Height: 200mm / 8" Weight: 0.5kg / 1.10lb	Width: 600mm / 24" Height: 280mm / 11" Weight: 0.9kg / 1.98lb	Width: 800mm / 31" Height: 370mm / 15" Weight: 1.5kg / 3.30lb	Width: 1000mm / 39" Height: 420mm / 17" Weight: 2.45kg / 5.40lb	Width: 1400mm / 55" Height: 650mm / 26" Weight: 9.2kg / 20.28lb	Dimensions
2m / 6.5ft	2m / 6.5ft	2m / 6.5ft	3m / 9.8ft	5m / 16.4ft	Cordset*
Bamboo plywood (Sourced from FSC accredited factory)	Bamboo plywood (Sourced from FSC accredited factory)	Bamboo plywood (Sourced from FSC accredited factory).	Bamboo plywood (Sourced from FSC accredited factory)	Bamboo plywood (Sourced from FSC accredited factory)	Material
Nylon	Nylon	Nylon	Nylon	Nylon	Fasteners
Hangs on cord	Hangs on cord	Hangs on cord	1 x Suspension Wire	4 x Suspension Wires	Suspension
565mm x 185mm x 70mm 22" x 7" x 3" 0.007m ³ / 0.3ft ³ 0.9kg / 2lb	570mm x 240mm x 60mm 22" x 9" x 2" 0.008m ³ / 0.29ft ³ 1.5kg / 3.31lb	395mm x 335mm x 105mm 16" x 13" x 4" 0.014m ³ / 0.5ft ³ 2.4kg / 5.3lb	540mm x 450mm x 80mm 21" x 18" x 3" 0.019m ³ / 0.674ft ³ 3.8kg / 8.38lb	750mm x 590mm x 205mm 30" x 23" x 8" 0.091m ³ / 3.2ft ³ 9.25kg / 20.4lb	Packaging

*Black comes with black cordset and fasteners. All others come with white cordset and white fasteners. Custom lengths available on request.

Finishes

We offer 12 stock finish options for Kina. We use low VOC acrylic paint and it is most commonly used on the interior of the light. We can also produce lights in other finishes or colours by special order. All lights are made from sustainably grown bamboo plywood sourced from an FSC accredited factory.



Raw Finish

Bamboo



Painted 2 Sides

Black



White

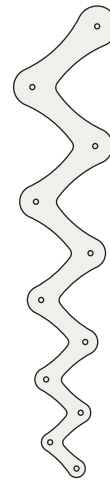

Painted 1 Side

Blue

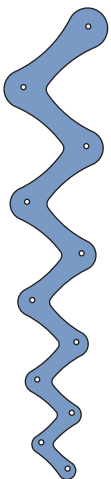

Aqua

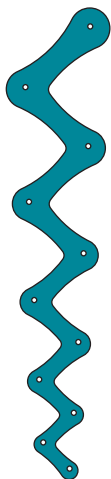

Lime

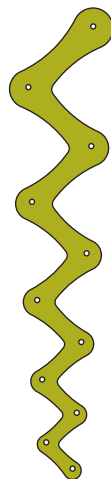

Orange

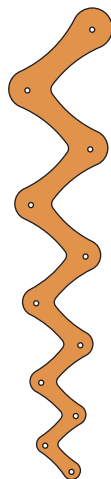

Pink

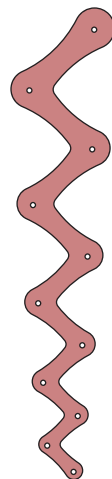

Red



Black



White

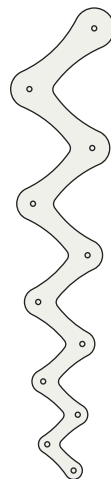

*Finishes apply to all Kina sizes



Bamboo



Aqua



Lime

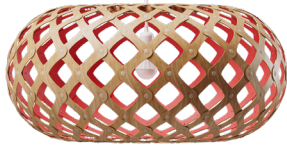

Red



Orange



Blue



Pink

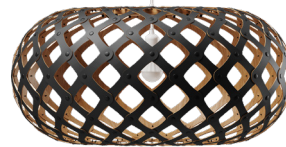

Black 1 Side (Outside)



Black 1 Side (Inside)



Black 2 Sides



White 1 Side



White 2 Sides

Electrics

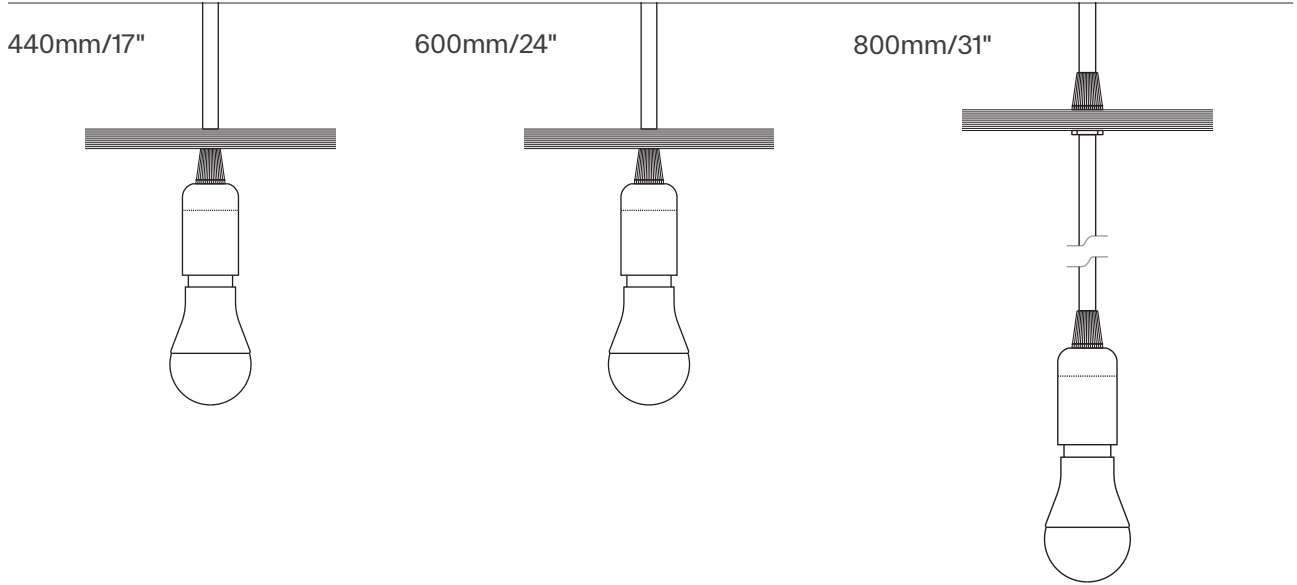

North America: E26,
Max 60 Watts 120v AC
60hz
Rest of World: E27,
Max 60 Watts
230-240v AC 50hz

North America: E26,
Max 60 Watts 120v
AC 60hz
Rest of World: E27,
Max 60 Watts
230-240v AC 50hz

North America: E26,
Max 60 Watts 120v
AC 60hz
Rest of World: E27,
Max 60 Watts
230-240v AC 50hz

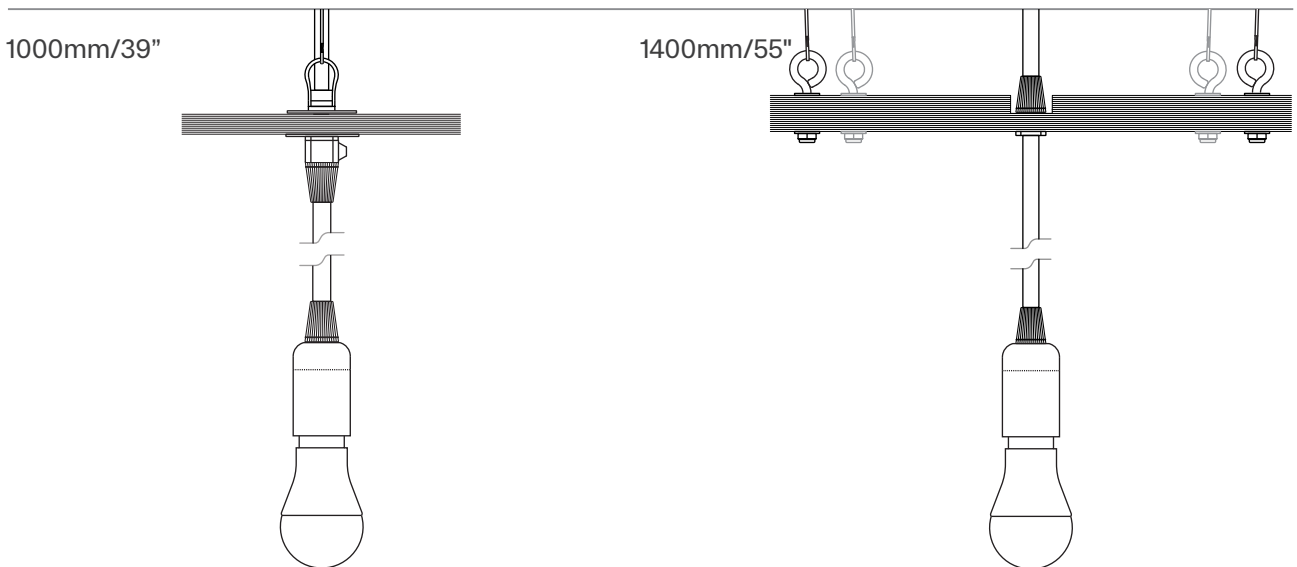

North America: E26,
Max 60 Watts 120v AC
60hz
Rest of World: E27,
Max 60 Watts
230-240v AC 50hz

North America: E26,
Max 60 Watts 120v AC
60hz
Rest of World: E27,
Max 60 Watts
230-240v AC 50hz

Installation

1000mm/39"

1400mm/55"

Fixings for cone gripper (fixing screws NOT SUPPLIED).

Note: Choose appropriate hardware to attach base plate (Fig.1) to ceiling substrate.

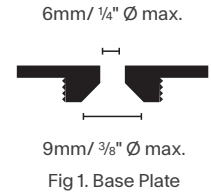

Options

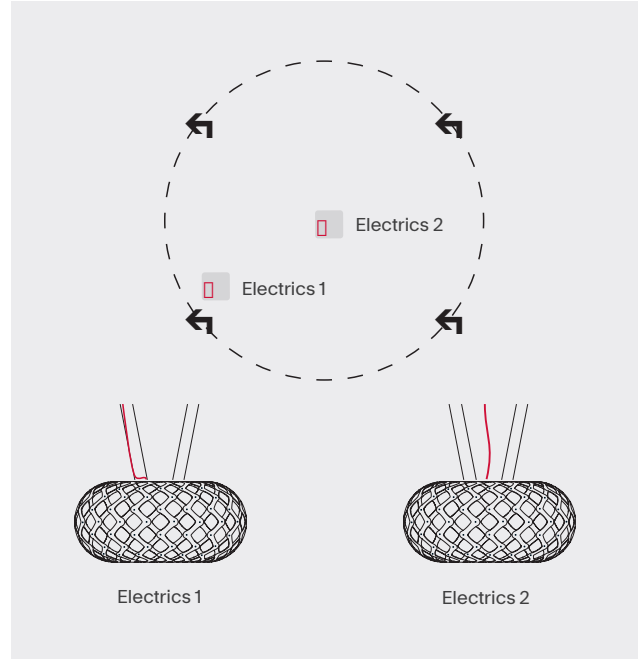
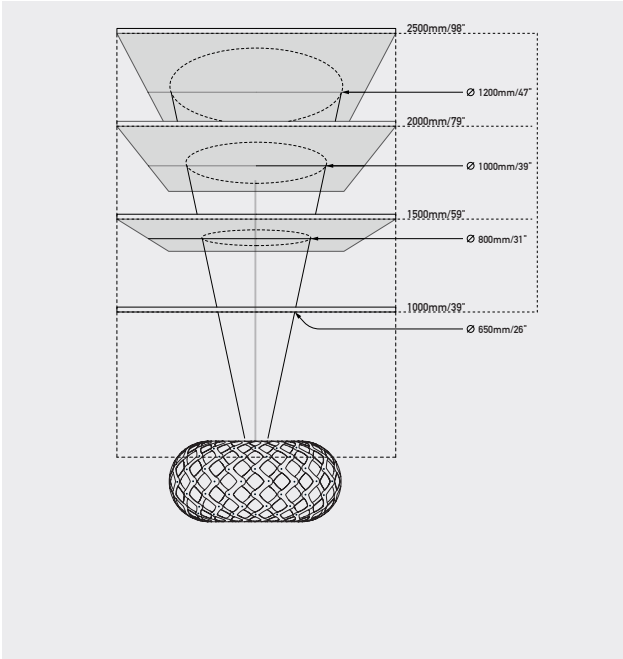

Step 1.

Decide upon hanging distance. Use the schematic diagram as a guide to pick a circle radius to be marked out on ceiling. This circle can be marked with a length of timber or string.

Step 2.

Mark 3 hanging points where your cone grippers will be located. You can either centrally locate the ceiling canopy or run the electric cord up one of the suspension wires.

Installation - 1000mm / 39" & 1400mm / 55"

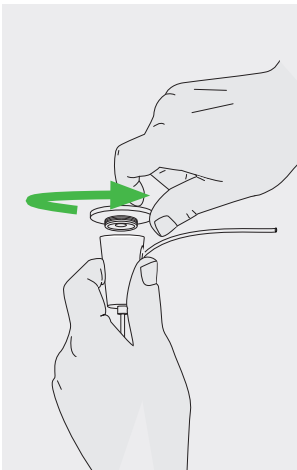

Step 1.
Unscrew baseplate.

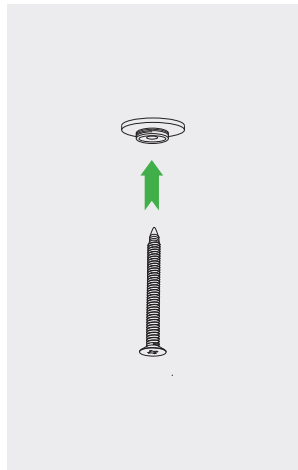

Step 2.
Use appropriate fixing screw to mount base plate (Fig.1).

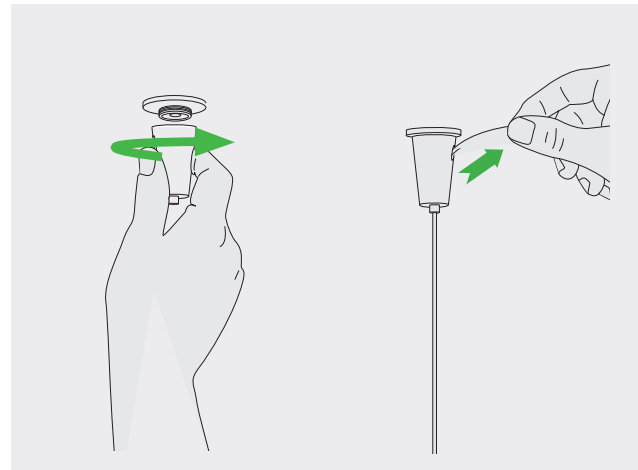

Step 3.
Remove cable from cone. Screw cone back onto baseplate. Re-insert cable and level light. Once desired position is set, trim excess cable.

) david
trubridge

davidtrubridge.com

David Trubridge Studio

Hawke's Bay, New Zealand

info@davidtrubridge.com

+64 6 650 0204

Certified



Corporation



sustainable
coastlines