



Sola



Sola

Based on the same geometry as Coral and Floral with more connection points, creating an intensely intricate pattern. Designed as part of our Icarus installation shown in Milan which is based on the Greek myth about the boy who flew too close to the Sun.

Sola represents the Sun which will get too hot if you fly too high and the shapes look a little like the solar flares that form and curl on the surface and edge of our Sun.

Sola is available in 2 sizes, 800mm/31" and 1000mm/39" The plywood finish can be either raw bamboo or painted, offering a range of options.



Features

Shipped Kitset

Seed System kitset lightshades are on average 1/30th of the volume of the assembled light. This aims to help minimize the effects of shipping and to reduce the design's environmental footprint.

Warranty

This light is warranted for three years from date of purchase for failure of parts.

Care Instructions

All lights are intended for use in dry interior conditions only and can be cleaned with a soft cloth dampened slightly in warm water when the light is switched off. Do not use detergents.

EPD Certified

An EPD is a standardised and verified way of quantifying the environmental impacts of a product, based on a consistent set of rules that have been developed through a stakeholder consultation process.



Compliance



CE



AS/NZS

(Declarations of conformity available on request).

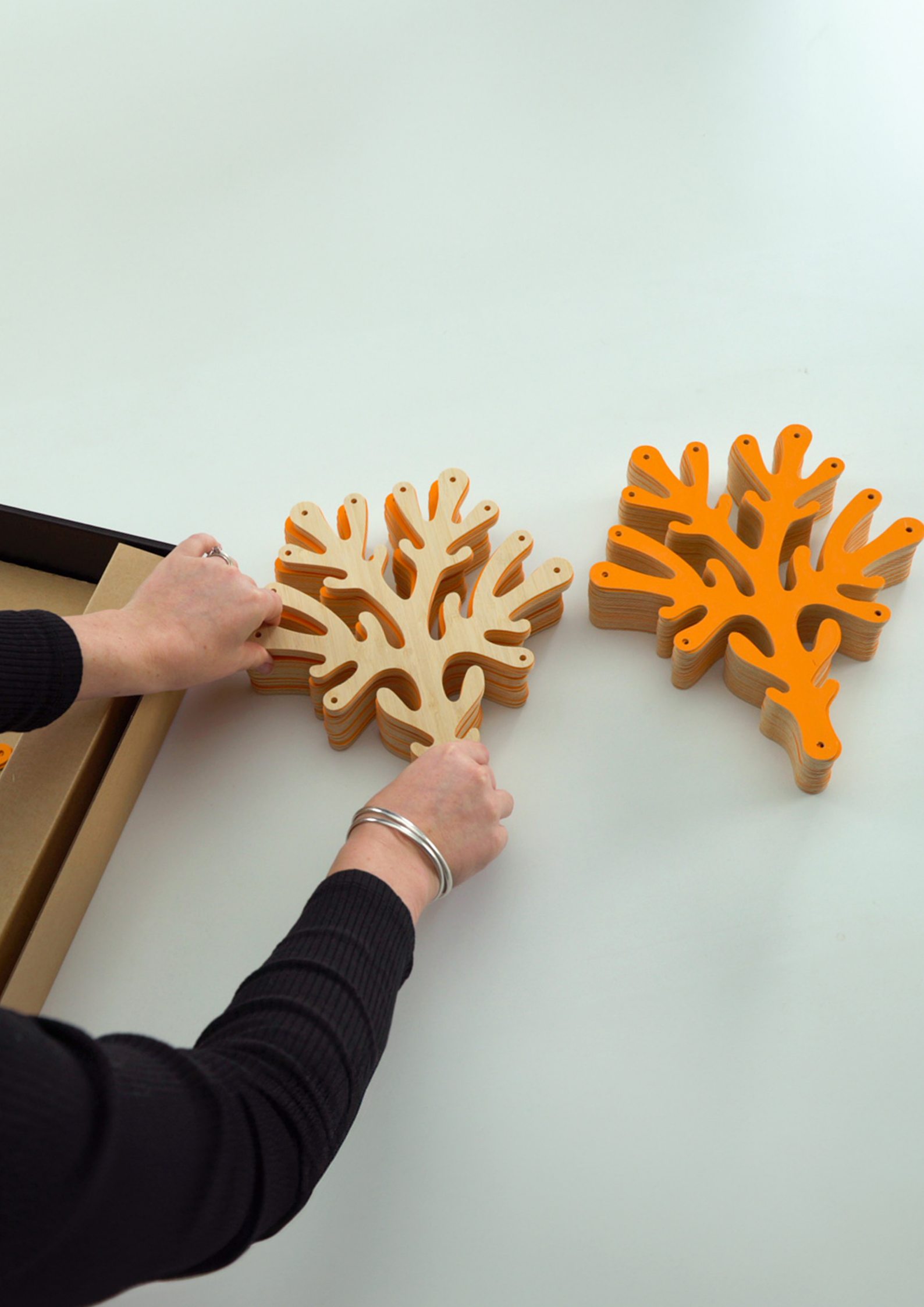

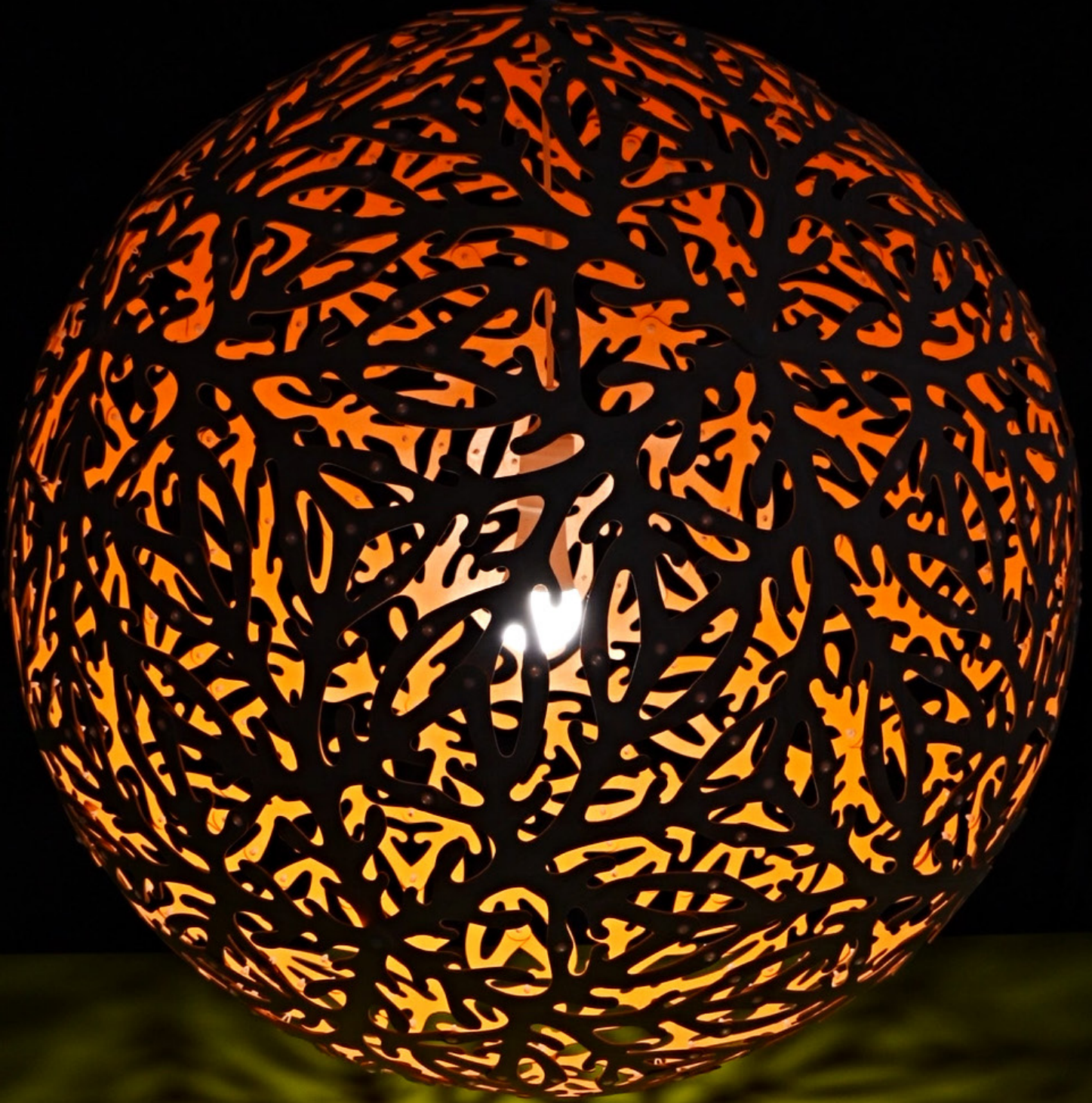

Technical Data

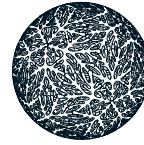

800mm/31"

1000mm/39"

1350mm/53"

	Dimensions	Cordset*	Material	Fasteners	Suspension	Packaging
	Diameter: 800mm / 31" Weight: 1.7kg / 3.75lb	2m / 6.5ft	Bamboo plywood (Sourced from FSC accredited factory)	Nylon	1 x Suspension Wire	360mm x 250mm x 130mm 14" x 10" x 5" 0.012m ³ / 0.413ft ³ 4.5kg / 9.92lb
	Diameter: 1000mm / 39" Weight: 2.3kg / 5.07lb	2m / 6.5ft	Bamboo plywood (Sourced from FSC accredited factory)	Nylon	1 x Suspension Wire	365mm x 320mm x 140mm 14" x 13" x 6" 0.016m ³ / 0.577ft ³ 5.0kg / 11.02lb
	Diameter: 1350mm / 53" Weight: 7kg / 15.43lb	5m / 16.4ft	Bamboo plywood (Sourced from FSC accredited factory)	Nylon	1 x Suspension Wire	480mm x 420mm x 185mm 19" x 17" x 7" 0.040m ³ / 1.317ft ³ 8.0kg / 17.64lb

*Black comes with black cordset and fasteners. All others come with white cordset and white fasteners. Custom lengths available on request.

Finishes

We offer 12 stock finish options for Sola. We use low VOC acrylic paint and it is most commonly used on the interior of the light. We can also produce lights in other finishes or colours by special order. All lights are made from sustainably grown bamboo plywood sourced from an FSC accredited factory.



Raw Finish

Bamboo

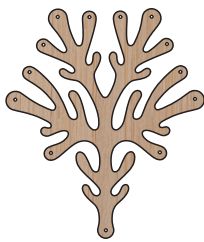

Painted 2 Sides

Black

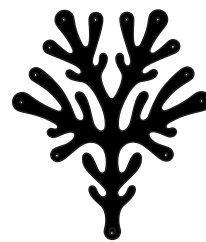

White

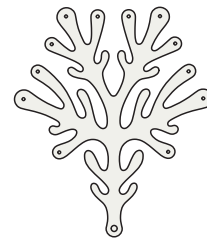

Painted 1 Side

Blue

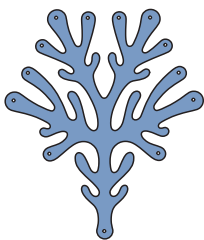

Aqua

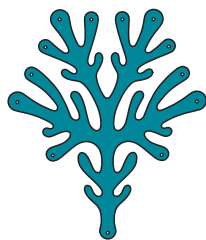

Lime

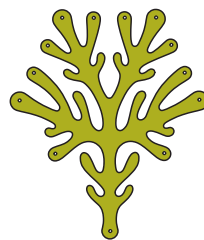

Orange

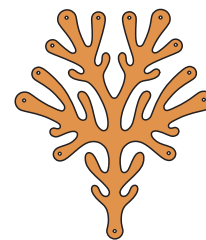

Pink

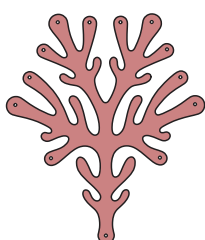

Red

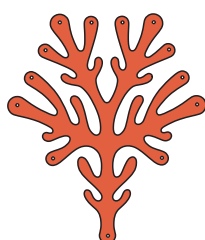

Black

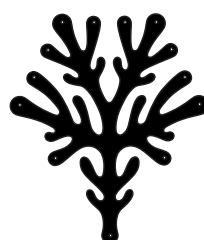

White

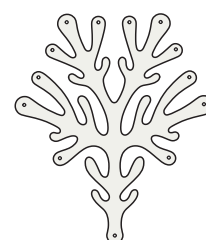



Bamboo



Aqua



Lime



Red



Orange

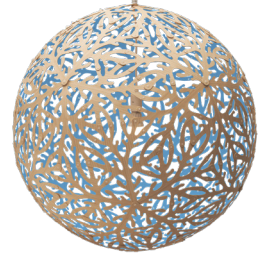

Blue



Pink



Black 1 Side (Outside)



Black 1 Side (Inside)



Black 2 Sides



White 1 Side



White 2 Sides

Electrics

800mm/31"
1000mm/39"
1350mm/53"

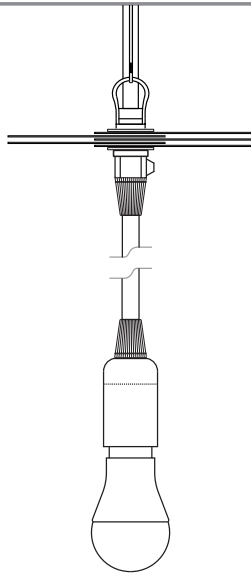

North America: E26,
Max 60 Watts 120v AC
60hz
Rest of World: E27,
Max 60 Watts
230-240v AC 50hz.

Installation

800mm/31"

1000mm/39"

1350mm/53"

Fixings for cone gripper (fixing screws NOT SUPPLIED).

Note: Choose appropriate hardware to attach base plate (Fig.1) to ceiling substrate.

6mm/ ¼" Ø max.



9mm/ ⅜" Ø max.

Fig 1. Base Plate

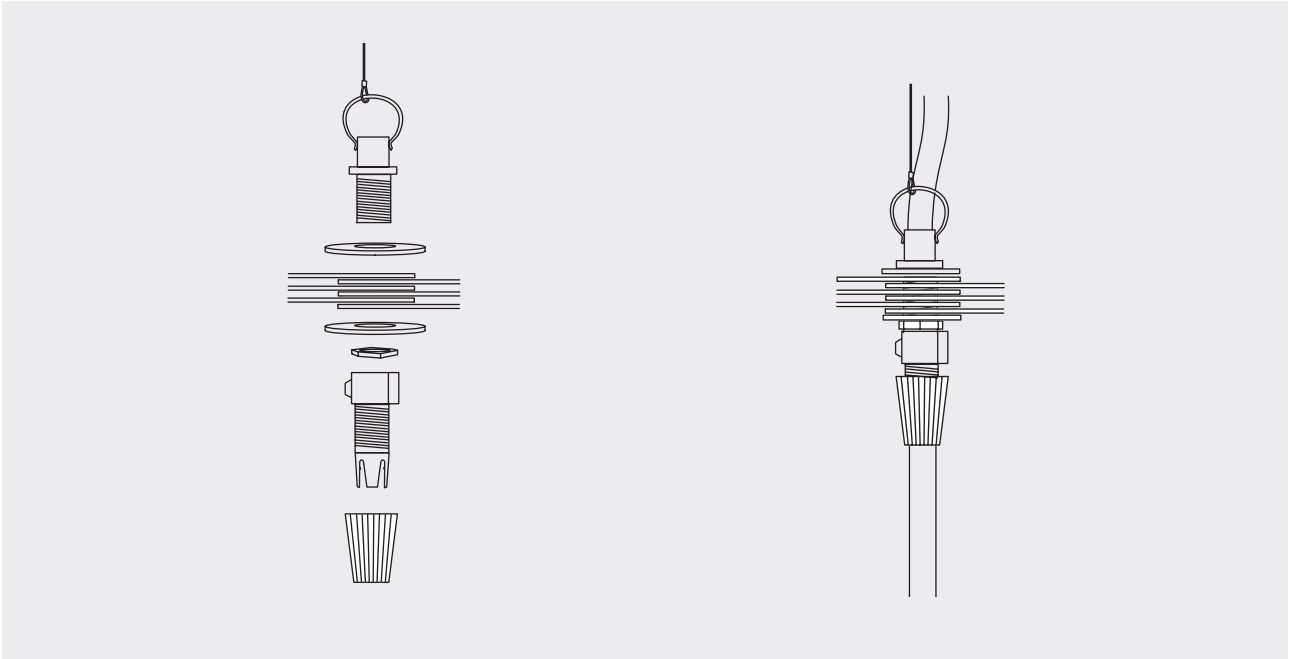

Step 1.

Follow the order of each component in diagram. Adjust the bulb / lamp to mid way in the pendant lightshade shown in Step 2 and then tighten.

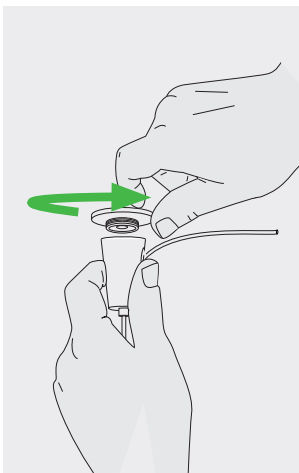

Step 2.

Unscrew baseplate.

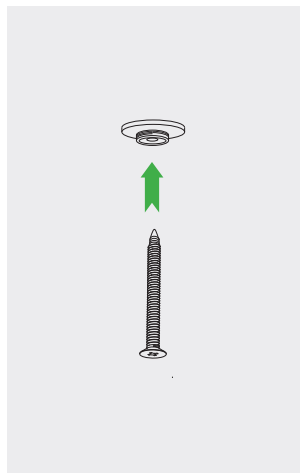

Step 3.

Use appropriate fixing screw to mount base plate (Fig.1).

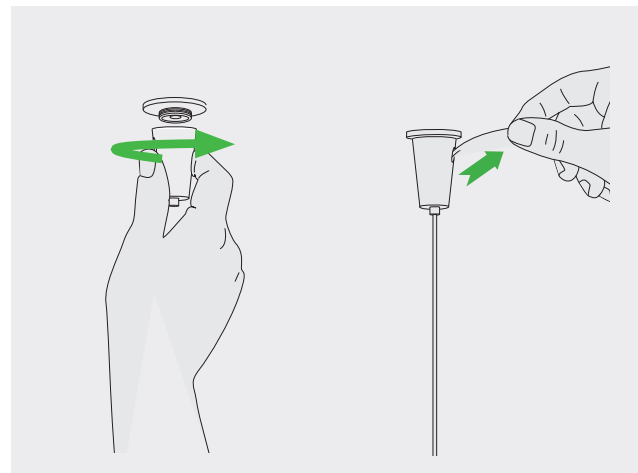

Step 4.

Remove cable from cone. Screw cone back onto baseplate. Re-insert cable and level light. Once desired position is set, trim excess cable.

) david
trubridge

davidtrubridge.com

David Trubridge Studio

Hawke's Bay, New Zealand

info@davidtrubridge.com

+64 6 650 0204

Certified



Corporation



sustainable
coastlines